



DEPARTMENT OF REGULATORY AND ECONOMIC RESOURCES (RER)
BOARD AND CODE ADMINISTRATION DIVISION

MIAMI-DADE COUNTY
PRODUCT CONTROL SECTION
11805 SW 26 Street, Room 208
Miami, Florida 33175-2474
T (786) 315-2590 F (786) 315-2599
www.miamidade.gov/economy

NOTICE OF ACCEPTANCE (NOA)

Layze Systems
3520 N.W. 51 Street
Miami, Florida 33142

SCOPE:

This NOA is being issued under the applicable rules and regulations governing the use of construction materials. The documentation submitted has been reviewed and accepted by Miami-Dade County RER- Product Control Section to be used in Miami Dade County and other areas where allowed by the Authority Having Jurisdiction (AHJ).

This NOA shall not be valid after the expiration date stated below. The Miami-Dade County Product Control Section (In Miami Dade County) and/or the AHJ (in areas other than Miami Dade County) reserve the right to have this product or material tested for quality assurance purposes. If this product or material fails to perform in the accepted manner, the manufacturer will incur the expense of such testing and the AHJ may immediately revoke, modify, or suspend the use of such product or material within their jurisdiction. RER reserves the right to revoke this acceptance if it is determined by Miami-Dade County Product Control Section that this product or material fails to meet the requirements of the applicable building code.

This product is approved as described herein and has been designed to comply with the High Velocity Hurricane Zone of the Florida Building Code.

DESCRIPTION: Aluminum and Canvas Terrace Awning

APPROVAL DOCUMENT: Drawing No. EA-01, titled "Layze Shade - Series 002", sheets 1 through 10 of 10, prepared by Eastern Engineering Group, last revision #5, dated June 08, 2022, signed and sealed by Gonzalo A. Paz, P.E., on June 08, 2022, bearing the Miami-Dade County Product Control Revision stamp with the Notice of Acceptance number and the expiration date by the Miami-Dade County Product Control Section.

MISSILE IMPACT RATING: None

LABELING: Each awning shall bear a permanent label with the manufacturer's name or logo, city, state and the following statement: "Miami-Dade County Product Control Approved", unless otherwise noted herein.

RENEWAL of this NOA shall be considered after a renewal application has been filed and there has been no change in the applicable building code negatively affecting the performance of this product.

TERMINATION of this NOA will occur after the expiration date or if there has been a revision or change in the materials, use, and/or manufacture of the product or process. Misuse of this NOA as an endorsement of any product, for sales, advertising or any other purposes shall automatically terminate this NOA. Failure to comply with any section of this NOA shall be cause for termination and removal of NOA.

ADVERTISEMENT: The NOA number preceded by the words Miami-Dade County, Florida, and followed by the expiration date may be displayed in advertising literature. If any portion of the NOA is displayed, then it shall be done in its entirety.

INSPECTION: A copy of this entire NOA shall be provided to the user by the manufacturer or its distributors and shall be available for inspection at the job site at the request of the Building Official.

This NOA **revises and renews** NOA #18-0924.05 and consists of this page 1, evidence submitted pages E-1, E-2 and E-3 as well as approval document mentioned above.

The submitted documentation was reviewed by **Helmy A. Makar, P.E., M.S.**



Helmy A. Makar
07/28/2022

NOA No. 21-1209.05
Expiration Date: 12/15/2026
Approval Date: 07/28/2022

Layze Systems

NOTICE OF ACCEPTANCE: EVIDENCE SUBMITTED

1. EVIDENCE SUBMITTED UNDER PREVIOUS APPROVAL #11-0908.08

A. DRAWINGS

1. *Drawing No. EA-01, titled “ Layze Shade – Series 002 ”, prepared by Eastern Engineering Group, last revision #1, dated December 06, 2011, signed and sealed by Gonzalo A. Paz, P.E., on December 06, 2011.*

B. TESTS

1. *None.*

C. CALCULATIONS

1. *Calculations titled “Layze Shade Series 002 Awning Aluminum frame”, prepared by eastern Engineering Group, dated September 06, 2011, 70 sheets, signed and sealed by Gonzalo A. Paz, P.E.*
2. *Calculations titled “Layze Shade Series 002 Awning Aluminum frame”, prepared by eastern Engineering Group, dated November 30, 2011, 13 sheets, signed and sealed by Gonzalo A. Paz, P.E.*

D. QUALITY ASSURANCE

1. *By Miami-Dade County Department of Permitting, Environment, and Regulatory Affairs (PERA).*

E. MATERIAL CERTIFICATIONS

1. *None.*

2. EVIDENCE SUBMITTED UNDER PREVIOUS APPROVAL #13-0430.13

A. DRAWINGS

1. *Drawing No. EA-01, titled “ Layze Shade – Series 002 ”, prepared by Eastern Engineering Group, last revision #2, dated April 10, 2013, signed and sealed by Gonzalo A. Paz, P.E., on April 10, 2013.*

B. TESTS

1. *None.*

C. CALCULATIONS

1. *Calculations titled “Layze Shade Series 002 Awning Aluminum frame”, prepared by eastern Engineering Group, dated April 10, 2013, 3 sheets, signed and sealed by Gonzalo A. Paz, P.E.*

D. QUALITY ASSURANCE

1. *By Miami-Dade County Department of Regulatory and Economic Resources.*

E. MATERIAL CERTIFICATIONS

1. *None.*

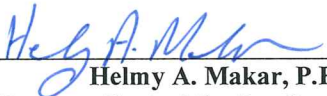

Helmy A. Makar, P.E., M.S.
Product Control Section Supervisor
NOA No. 21-1209.05
Expiration Date: 12/15/2026
Approval Date: 07/28/2022

Layze Systems

NOTICE OF ACCEPTANCE: EVIDENCE SUBMITTED

3. EVIDENCE SUBMITTED UNDER PREVIOUS APPROVAL #16-1208.03

A. DRAWINGS

1. *Drawing No. EA-01, titled " Layze Shade – Series 002 ", prepared by Eastern Engineering Group, last revision #3, dated November 20, 2016, signed and sealed by Gonzalo A. Paz, P.E., on December 06, 2016.*

B. TESTS

1. *None.*

C. CALCULATIONS

1. *None.*

D. QUALITY ASSURANCE

1. *By Miami-Dade County Department of Regulatory and Economic Resources.*

E. MATERIAL CERTIFICATIONS

1. *None.*

4. EVIDENCE SUBMITTED UNDER PREVIOUS APPROVAL #18-0924.05

A. DRAWINGS

1. *Drawing No. EA-01, titled " Layze Shade – Series 002 ", prepared by Eastern Engineering Group, last revision #4, dated August 27, 2018, signed and sealed by Gonzalo A. Paz, P.E., on August 28, 2018.*

B. TESTS

1. *None.*

C. CALCULATIONS

1. *None.*

D. QUALITY ASSURANCE

1. *By Miami-Dade County Department of Regulatory and Economic Resources.*

E. MATERIAL CERTIFICATIONS

1. *None.*



Helmy A. Makar, P.E., M.S.
Product Control Section Supervisor
NOA No. 21-1209.05
Expiration Date: 12/15/2026
Approval Date: 07/28/2022

Layze Systems

NOTICE OF ACCEPTANCE: EVIDENCE SUBMITTED

5. NEW EVIDENCE SUBMITTED

A. DRAWINGS

1. *Drawing No. EA-01, titled "Layze Shade - Series 002", sheets 1 through 10 of 10, prepared by Eastern Engineering Group, last revision #5, dated June 08, 2022, signed and sealed by Gonzalo A. Paz, P.E., on June 08, 2022.*

B. TESTS

1. *None.*

C. CALCULATIONS

1. *None.*

D. QUALITY ASSURANCE

1. *By Miami-Dade County Department of Regulatory and Economic Resources.*

E. MATERIAL CERTIFICATIONS

1. *None.*



Helmy A. Makar, P.E., M.S.
Product Control Section Supervisor

NOA No. 21-1209.05

Expiration Date: 12/15/2026

Approval Date: 07/28/2022

LAYZE SHADE - SERIES 002

ALUMINUM AND FABRIC TERRACE AWNING

TABLE OF CONTENTS

SHEET	REVISION	SHEET DESCRIPTION
EA-01		GENERAL NOTES, INSTALLATION NOTES, TABLE OF CONTENTS, BILL OF MATERIALS AND COMPONENTS
EA-02		ISOMETRICS
EA-03		PLAN VIEW
EA-04		FRONT ELEVATION
EA-05		SIDE ELEVATION
EA-06		ELEMENTS 001 AND 002
EA-07		ELEMENTS 003 AND 004
EA-08		ELEMENTS 005 AND 006
EA-09		ELEMENTS 007
EA-10		ELEMENTS 009 & 010

BILL OF MATERIALS			
NO	DESCRIPTION	NOTES	QUANTITY
001	ELEMENT 001	ALUMINUM ALLOY 6061-T6	1
002	ELEMENT 002	ALUMINUM ALLOY 6061-T6	7
003	ELEMENT 003	ALUMINUM ALLOY 6061-T6	7
004	ELEMENT 004	ALUMINUM ALLOY 6061-T6	7
005	ELEMENT 005	ALUMINUM ALLOY 6061-T6	7
006	ELEMENT 006	ALUMINUM ALLOY 6061-T6	1
007	ELEMENT 007	ALUMINUM ALLOY 6061-T6	3
008	ELEMENT 008	5/16" BOLT WITH NUT - ALUMINUM ALLOY 7075-T73 28 UNF	12
009	ELEMENT 009	ALUMINUM ALLOY 6061-T6	3
010	ELEMENT 010	ALUMINUM ALLOY 6061-T6	3
011	ELEMENT 011	1/4" BOLT WITH NUT - ALUMINUM ALLOY 7075-T73 28 UNF	7
012	ELEMENT 012	1/4" KWIK CON II BY HILTI	28
013	ELEMENT 013	1/2" HOT-DIP GALVANIZED KWIK BOLT 3 BY HILTI	28
014	ELEMENT 014	10-16 S.S KWIK-FLEX SCREWS BY HILTI or APPROVED EQUAL	6
015	ELEMENT 015	S.S SOCKET SET SCREW 1/4"-20 CONE POINT	24

NOTE:

1- THIS PRODUCT HAS BEEN DESIGNED TO COMPLY WITH THE REQUIREMENTS OF THE FLORIDA BUILDING CODE 2022 EDITION, UNDER THE FOLLOWING CONDITIONS:

- BASIC WIND SPEED OF 105 MPH AS PER FBC 2022 SECTION 105.4.2 (FOR WIND EVENTS GREATER THAN 105 MPH, FABRIC CANVAS SHALL BE UP TO REMOVED).
- GUST FACTOR=0.85
- EXPOSURE CATEGORY='C'.
- DIRECTIONALITY FACTOR=0.85.
- TOPOGRAPHIC FACTOR=1.0

(MAXIMUM STRUCTURE HEIGHT WHERE AWNING IS ATTACHED SHALL BE 60 FEET)

- ANCHORS SHALL BE AS LISTED ON BILL OF MATERIALS. QUANTITIES AS SHOWN ON DETAILS. EMBEDMENT TO BASE MATERIAL SHALL BE BEYOND WALL COVERING (STUCCO, TILE ETC.).

- ANCHORING CONDITIONS OTHER THAN THOSE SHOWN ON THESE DETAILS ARE NOT PART OF THIS APPROVAL.

- MATERIALS INCLUDING BUT NOT LIMITED TO STEEL/METAL SCREWS, THAT COME INTO CONTACT WITH OTHER DISSIMILAR MATERIALS SHALL BE PAINTED WITH ALKALI-RESISTANT COATINGS.

MAX. DESIGN PRESSURE RATING

+50/-50 PSF SHORT TERM

5 PSF DEAD LOAD

PRODUCT REVISED
as complying with the Florida
Building Code
Acceptance No 21-1209-05
Expiration Date 12/15/2026
By *Heg A. Paz*
Miami Data Product Control

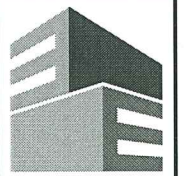
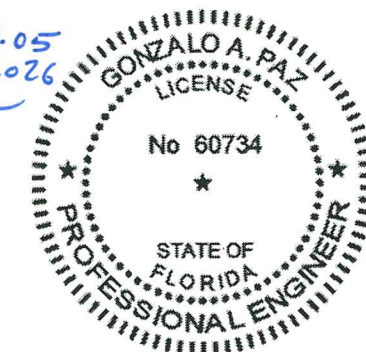

Eastern
Engineering Group

3401 NW 82nd Avenue
Suite 370
Miami, FL 33122

(305) 599-8133

info@easterneg.com

www.easterneg.com

NO.	DESCRIPTION	DATE
1	BOO COMMENTS	12/09/21
2	CODE CHANGE	04/10/23
3	CODE CHANGE	11/29/21
4	CODE CHANGE	07/27/21
5	CODE CHANGE	4/14/22
6	CODE CHANGE	9/9/22

JOB No. & NAME:	11 254
DESIGNED & DRAWN:	Mario Morales
SCALE:	AS SHOWN

LAYZE SHADE - SERIES 002
EASY TERRACE AWNINGS

Address : 3480 NW 21 AVENUE, MIAMI FL 33142
PH : 786-256-4564

HASSA R. LOPEZ, PE (Lic No-58389)
 GONZALO A. PAZ, PE (Lic No-60734)
CERT. OF AUTHORIZATION No. 26655
COPYRIGHT RESERVED. THE CONTENTS OF THIS DRAWING ARE THE PROPERTY OF EASTERN ENGINEERS GROUP. NO PART OF THIS DRAWING SHALL BE REPRODUCED OR TRANSMITTED IN ANY FORM OR BY ANY MEANS, ELECTRONIC OR MECHANICAL, INCLUDING PHOTOCOPYING, RECORDING, OR BY ANY INFORMATION STORAGE AND RETRIEVAL SYSTEM, WITHOUT THE WRITTEN PERMISSION OF EASTERN ENGINEERS GROUP. REPRODUCTION FOR ANY OTHER PURPOSE OTHER THAN THAT AUTHORIZED BY EASTERN ENGINEERS GROUP IS PROHIBITED. SHOP DRAWINGS CHECKED FOR STRUCTURAL REQUIREMENTS ONLY ON 7/2025

06/08/2022

EA-01
SHEET 1 OF 10

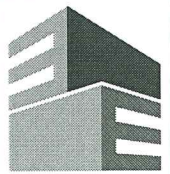

Eastern
Engineering Group

3401 NW 82nd Avenue
Suite 370
Miami, FL 33122

(305) 599-8133

info@easterneg.com

www.easterneg.com

REVISIONS	DATE
1	12/09/11
2	4/10/13

JOB No. & NAME:	11 254
DESIGNED & DRAWN:	Mario Morales
SCALE:	AS SHOWN

LAYZE SHADE - SERIES 002
EASY TERRACE AWNINGS
Address: 3480 NW 21 AVENUE, MIAMI FL 33142
PH: 786-256-4564

PRODUCT REVISED
as complying with the Florida
Building Code
Acceptance No 21-1209.05
Expiration Date 12/15/2026
By *Hely A. Paz*
Miami Design Product Control

06/08/2022

EA-02
SHEET 2 OF 10

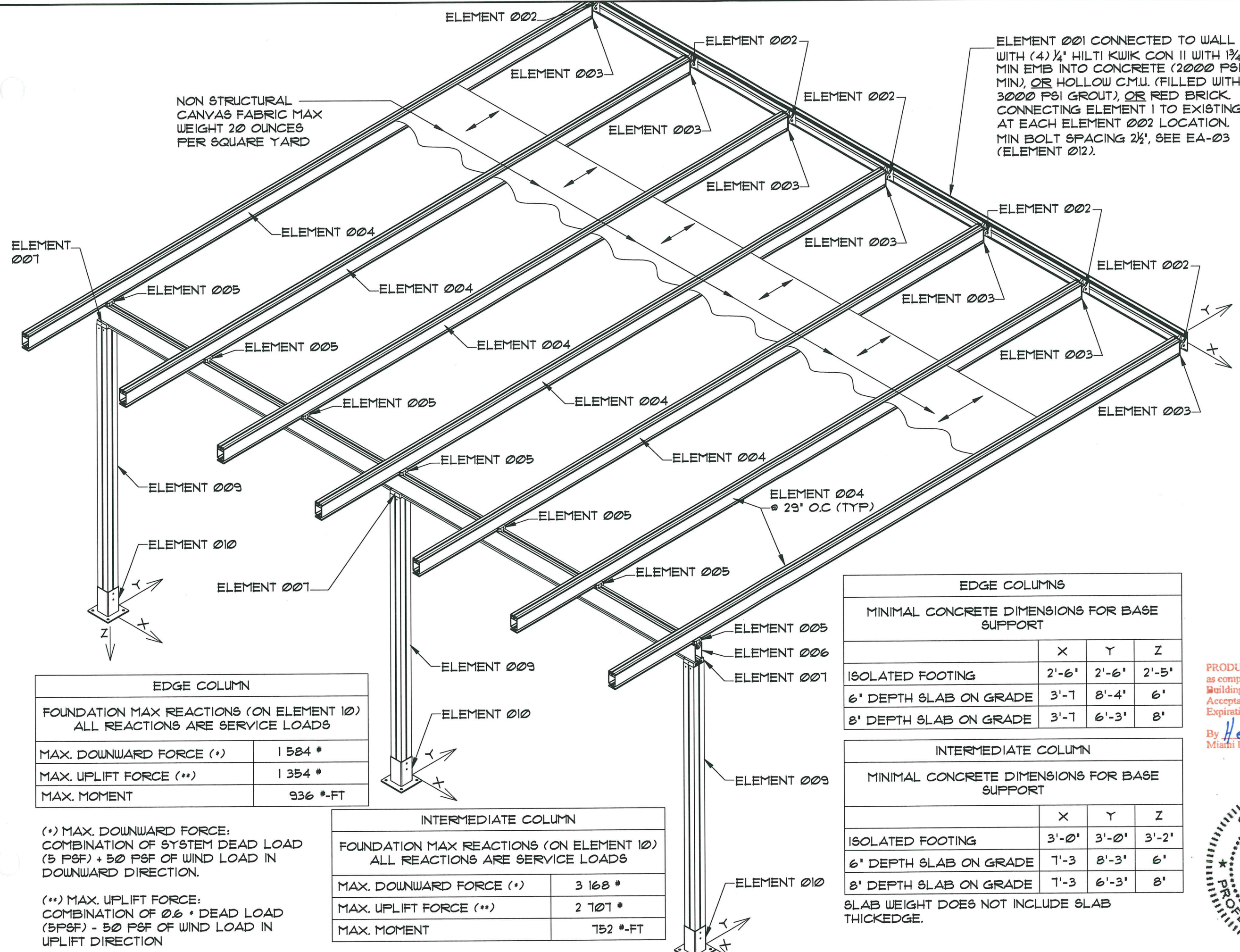

NON STRUCTURAL
CANVAS FABRIC MAX
WEIGHT 20 OUNCES
PER SQUARE YARD

ELEMENT 001 CONNECTED TO WALL
WITH (4) 1/4" HILTI KWIK CON II WITH 1 3/4"
MIN EMB INTO CONCRETE (2000 PSI
MIN), OR HOLLOW C.M.U. (FILLED WITH
3000 PSI GROUT), OR RED BRICK.
CONNECTING ELEMENT 1 TO EXISTING
AT EACH ELEMENT 002 LOCATION.
MIN BOLT SPACING 2 1/2", SEE EA-03
(ELEMENT 012).

EDGE COLUMN	
FOUNDATION MAX REACTIONS (ON ELEMENT 10) ALL REACTIONS ARE SERVICE LOADS	
MAX. DOWNWARD FORCE (*)	1 584 #
MAX. UPLIFT FORCE (**)	1 354 #
MAX. MOMENT	936 #-FT

(*) MAX. DOWNWARD FORCE:
COMBINATION OF SYSTEM DEAD LOAD
(5 PSF) + 50 PSF OF WIND LOAD IN
DOWNWARD DIRECTION.

(**) MAX. UPLIFT FORCE:
COMBINATION OF 0.6 * DEAD LOAD
(5PSF) - 50 PSF OF WIND LOAD IN
UPLIFT DIRECTION

INTERMEDIATE COLUMN	
FOUNDATION MAX REACTIONS (ON ELEMENT 10) ALL REACTIONS ARE SERVICE LOADS	
MAX. DOWNWARD FORCE (*)	3 168 #
MAX. UPLIFT FORCE (**)	2 707 #
MAX. MOMENT	752 #-FT

EDGE COLUMNS			
MINIMAL CONCRETE DIMENSIONS FOR BASE SUPPORT			
	X	Y	Z
ISOLATED FOOTING	2'-6"	2'-6"	2'-5"
6" DEPTH SLAB ON GRADE	3'-7"	8'-4"	6"
8" DEPTH SLAB ON GRADE	3'-7"	6'-3"	8"

INTERMEDIATE COLUMN			
MINIMAL CONCRETE DIMENSIONS FOR BASE SUPPORT			
	X	Y	Z
ISOLATED FOOTING	3'-0"	3'-0"	3'-2"
6" DEPTH SLAB ON GRADE	7'-3"	8'-3"	6"
8" DEPTH SLAB ON GRADE	7'-3"	6'-3"	8"

SLAB WEIGHT DOES NOT INCLUDE SLAB THICKEDGE.

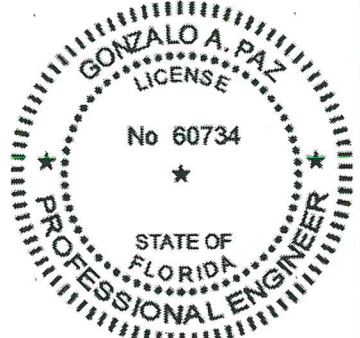

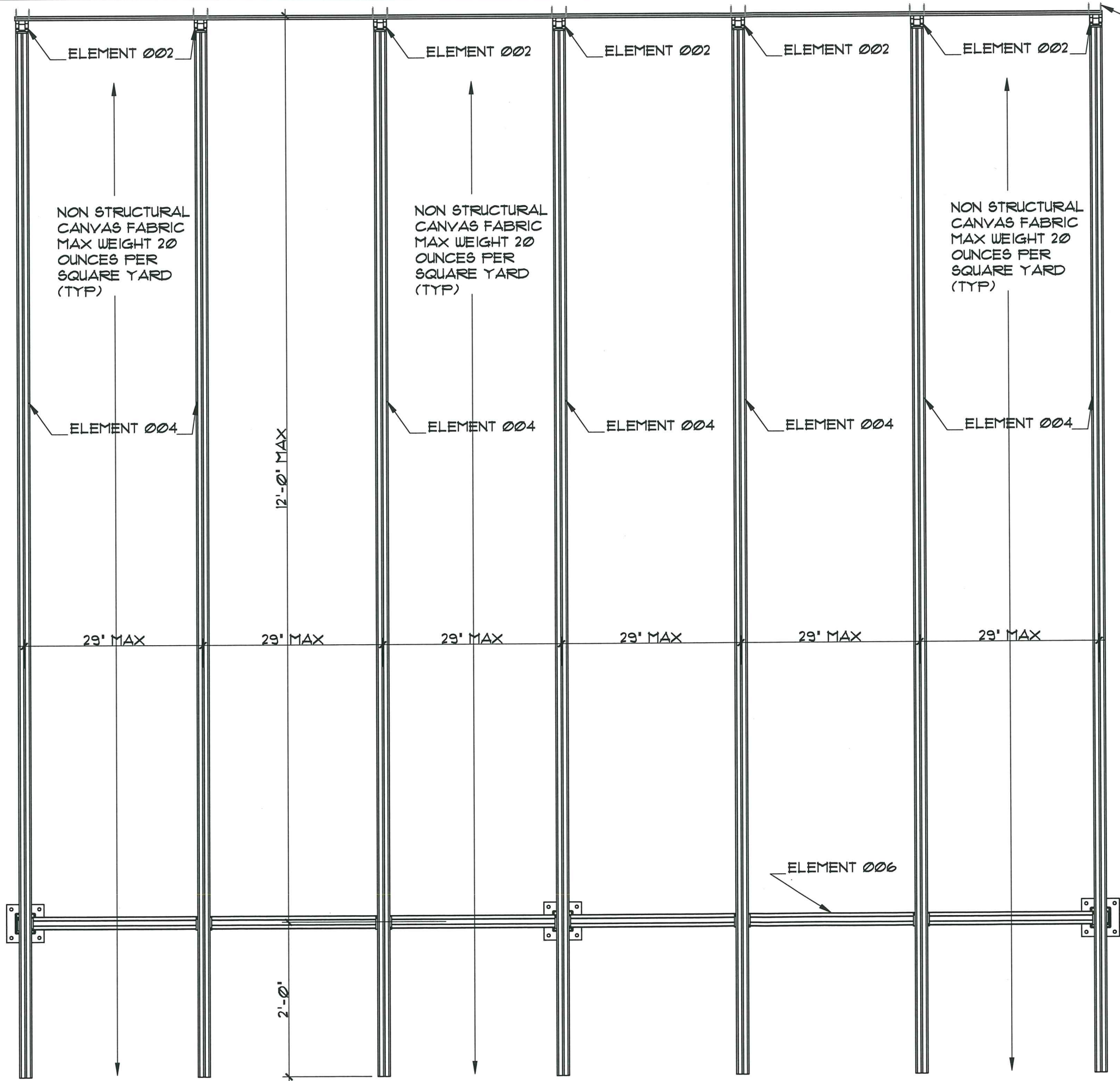

ELEMENT 012
 (4) 1/4" HILTI KWIK CON II WITH
 1 3/4" MIN EMB INTO CONCRETE
 (2000 PSI MIN), OR HOLLOW
 C.M.U. (FILLED WITH 3000 PSI
 GROUT) OR RED BRICK,
 CONNECTING ELEMENT 1 TO
 EXISTING AT EACH ELEMENT
 002 LOCATION. MIN BOLT
 SPACING 2 1/2". (TYP)

NON STRUCTURAL
 CANVAS FABRIC
 MAX WEIGHT 20
 OUNCES PER
 SQUARE YARD
 (TYP)

NON STRUCTURAL
 CANVAS FABRIC
 MAX WEIGHT 20
 OUNCES PER
 SQUARE YARD
 (TYP)

NON STRUCTURAL
 CANVAS FABRIC
 MAX WEIGHT 20
 OUNCES PER
 SQUARE YARD
 (TYP)

PRODUCT REVISED
 as complying with the Florida
 Building Code
 Acceptance No 21-1209.05
 Expiration Date 12/15/2026
 By *Hely A. Albin*
 Miami Data Product Control

A
EA-3

PLAN VIEW
SCALE: 3/4" = 1'-0"

GONZALO A. PAZ
LICENSE
No 60734
PROFESSIONAL ENGINEER
STATE OF FLORIDA

Eastern
Engineering Group

3401 NW 82nd Avenue
Suite 370
Miami, FL 33122

(305) 599-8133

info@easterneg.com
www.easterneg.com

REVISIONS	No.	DESCRIPTION	DATE
1	BIDD COMMENTS	12/09/11	
2	CODE CHANGE	4/10/13	

JOB No. & NAME:
11 254

DESIGNED & DRAWN:
Mario Morales

SCALE: AS SHOWN

LAYE SHADE - SERIES 002
 EASY TERRACE AWNING

Address: 3480 NW 21 AVENUE, MIAMI FL 33142
 PH: 786-256-4564

DANSA R. LOPEZ, PE (Lic No-50390)
 GONZALO A. PAZ, PE (Lic No-60734)
 CERT. OF AUTHORIZATION No. 26655

DO NOT SCALE THE DRAWING. ANY ERRORS OR OMISSIONS ARE THE RESPONSIBILITY OF THE DESIGNER. THE ENGINEER GROUP WHOSE NAME IS ON THIS DRAWING IS NOT RESPONSIBLE FOR ANY ERRORS OR OMISSIONS. THE ENGINEER GROUP WHOSE NAME IS ON THIS DRAWING IS NOT RESPONSIBLE FOR ANY ERRORS OR OMISSIONS. THE ENGINEER GROUP WHOSE NAME IS ON THIS DRAWING IS NOT RESPONSIBLE FOR ANY ERRORS OR OMISSIONS.

06/08/2022

EA-03
 SHEET 3 OF 10

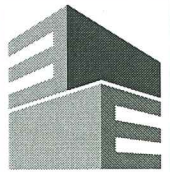

Eastern Engineering Group

3401 NW 82nd Avenue
Suite 370
Miami, FL 33122

(305) 599-8133

info@easterneg.com

www.easterneg.com

REVISIONS	DATE
No. DESCRIPTION	
1 ADD COMMENTS 11/20/11	
2 CODE CHANGE 4/10/13	

JOB No. & NAME:	11 254
DESIGNED & DRAWN:	Merio Morales
SCALE:	AS SHOWN

LAYZE SHADE - SERIES 002
EASY TERRACE AWNINGS
Address : 3480 NW 21 AVENUE, MIAMI FL 33142
PH : 786-256-4564

RANSA R. LOPEZ, PE (Lic No-80389)
 GONZALO A. PAZ, PE (Lic No-60734)
 CERT. OF AUTHORIZATION No. 26655
DO NOT SCALE THE DRAWING. ANY ERRORS OR OMISSIONS ARE THE RESPONSIBILITY OF THE DESIGNER. THE ENGINEER GROUP WHOSE NAME IS ON THE DRAWING IS NOT RESPONSIBLE FOR ANY ERRORS OR OMISSIONS. THE ENGINEER GROUP WHOSE NAME IS ON THE DRAWING IS NOT RESPONSIBLE FOR ANY ERRORS OR OMISSIONS. THE ENGINEER GROUP WHOSE NAME IS ON THE DRAWING IS NOT RESPONSIBLE FOR ANY ERRORS OR OMISSIONS.

06/08/2022

EA-04
SHEET 4 OF 10

ELEMENT 012
 (4) 1/4" HILTI KWIK CON II WITH 1 3/4" MIN EMB INTO CONCRETE (2000 PSI MIN), OR HOLLOW C.M.U. (FILLED WITH 3000 PSI GROUT)
 OR RED BRICK, CONNECTING ELEMENT 1 TO EXISTING AT EACH ELEMENT 002 LOCATION. MIN BOLT SPACING 2 1/2". (TYP)

29' MAX 29' MAX 29' MAX 29' MAX 29' MAX 29' MAX

ELEMENT 001

ELEMENT 004

ELEMENT 004

ELEMENT 004

ELEMENT 004

ELEMENT 004

ELEMENT 004

ELEMENT 008
 (2) 5/16" THRU BOLTS
 ALUMINUM T075-TT3
 MACHINE SCREWS
 CONNECTING ELEMENT
 007 WITH ELEMENT 009

ELEMENT 006

ELEMENT 008
 (2) 5/16" THRU BOLTS
 ALUMINUM T075-TT3
 MACHINE SCREWS
 CONNECTING ELEMENT
 007 WITH ELEMENT
 009

ELEMENT 008
 (2) 5/16" THRU BOLTS
 ALUMINUM T075-TT3
 MACHINE SCREWS
 CONNECTING ELEMENT
 007 WITH ELEMENT
 009

ELEMENT 009

ELEMENT 009

8'-0" MAX

ELEMENT 008
 (2) 5/16" THRU BOLTS
 ALUMINUM T075-TT3
 MACHINE SCREWS
 CONNECTING ELEMENT
 009 WITH ELEMENT 010

7'-3" MAX

ELEMENT 008
 (2) 5/16" THRU BOLTS
 ALUMINUM T075-TT3
 MACHINE SCREWS
 CONNECTING ELEMENT
 009 WITH ELEMENT 010

7'-3" MAX

ELEMENT 008
 (2) 5/16" THRU BOLTS
 ALUMINUM T075-TT3
 MACHINE SCREWS
 CONNECTING ELEMENT
 009 WITH ELEMENT 010

ELEMENT 010 CONNECTED TO 3000 PSI MIN
 CONCRETE WITH (4) HOT-DIP GALVANIZED 1/2"
 KWIK BOLT 3 BY HILTI WITH 4 3/4" EMBEDMENT,
 MIN EDGE DIST 6" (TYP)



FRONT ELEVATION

SCALE: 1"=1'-0"

PRODUCT REVISED
 as complying with the Florida
 Building Code
 Acceptance No 21-1209.05
 Expiration Date 12/15/2026
 By *H. G. P. Paz*
 Miami Data Product Control

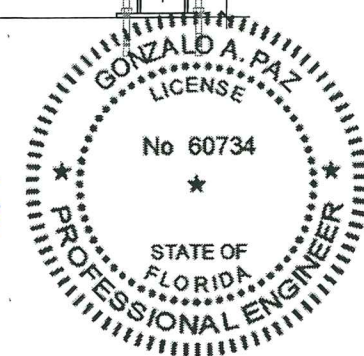

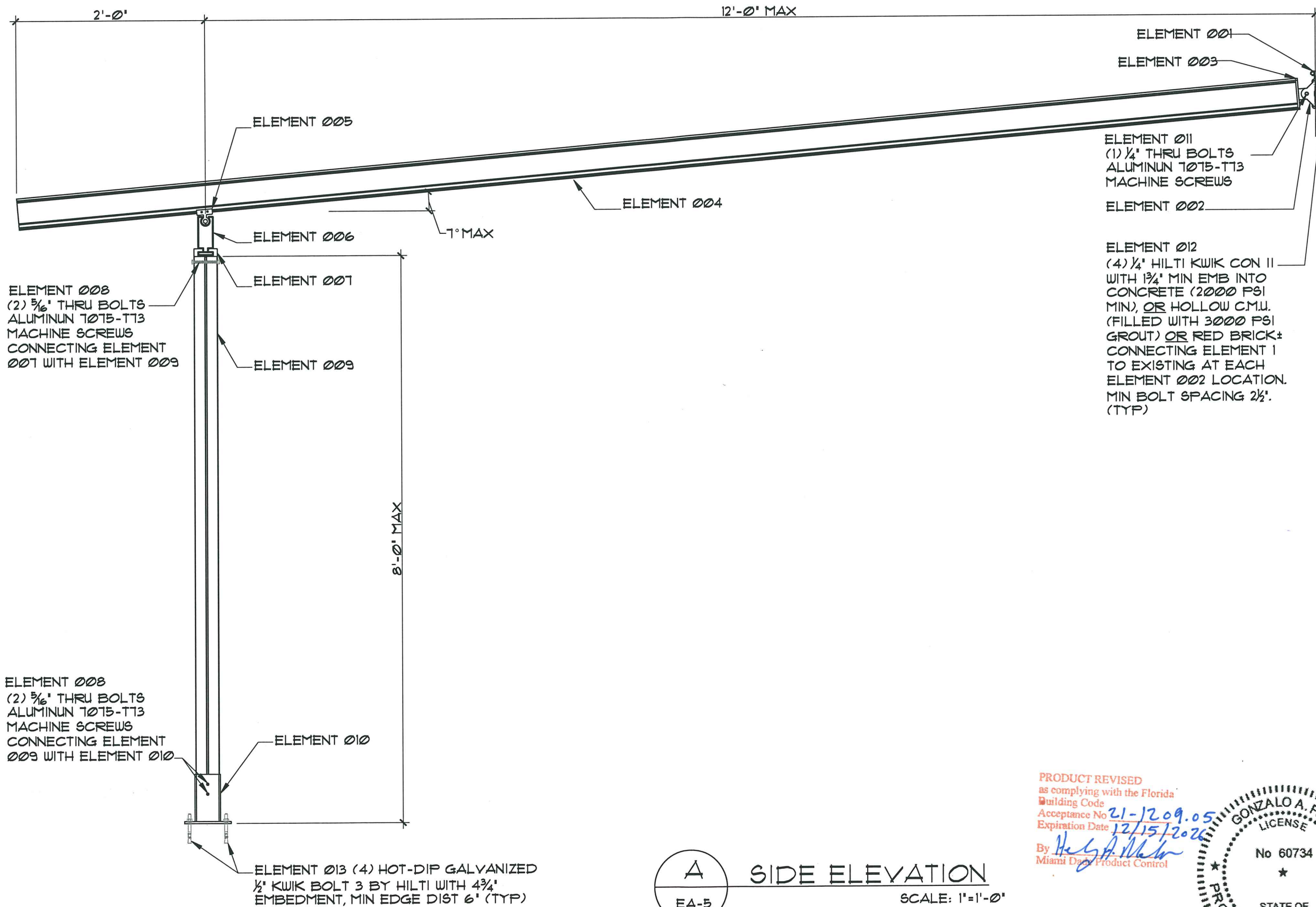

ELEMENT 008
 (2) 5/16" THRU BOLTS
 ALUMINUM T075-T13
 MACHINE SCREWS
 CONNECTING ELEMENT
 007 WITH ELEMENT 009

ELEMENT 008
 (2) 5/16" THRU BOLTS
 ALUMINUM T075-T13
 MACHINE SCREWS
 CONNECTING ELEMENT
 009 WITH ELEMENT 010

ELEMENT 013 (4) HOT-DIP GALVANIZED
 1/2" KWIK BOLT 3 BY HILTI WITH 4 3/4"
 EMBEDMENT, MIN EDGE DIST 6" (TYP)

ELEMENT 001
 ELEMENT 003
 ELEMENT 011
 (1) 1/4" THRU BOLTS
 ALUMINUM T075-T13
 MACHINE SCREWS
 ELEMENT 002

ELEMENT 012
 (4) 1/4" HILTI KWIK CON II
 WITH 1 3/4" MIN EMB INTO
 CONCRETE (2000 PSI
 MIN), OR HOLLOW C.M.U.
 (FILLED WITH 3000 PSI
 GROUT) OR RED BRICK±
 CONNECTING ELEMENT 1
 TO EXISTING AT EACH
 ELEMENT 002 LOCATION.
 MIN BOLT SPACING 2 1/2".
 (TYP)

A
 EA-5

SIDE ELEVATION

SCALE: 1"=1'-0"

PRODUCT REVISED
 as complying with the Florida
 Building Code
 Acceptance No. 21-1209.05
 Expiration Date 12/15/2026
 By *Hedy A. Martin*
 Miami Data Product Control



Eastern
 Engineering Group
 3401 NW 82nd Avenue
 Suite 370
 Miami, FL 33122
 (305) 599-8133
 info@easterneg.com
 www.easterneg.com

REV. NO.	DESCRIPTION	DATE
1	ISSUE COMMENTS	11/20/21
2	CODE CHANGE	4/10/23

JOB No. & NAME:	11 254
DESIGNED & DRAWN:	Mario Morales
SCALE:	AS SHOWN

LAYZE SHADE - SERIES 002
 EASY TERRACE AWNINGS
 Address : 3480 NW 21 AVENUE, MIAMI FL 33142
 PH : 786-256-4564

RASSA B. LOPEZ, PE (Lic No. 50399)
 GONZALO A. PAZ, PE (Lic No. 60734)
 CERT. OF AUTHORIZATION No. 26655
COPYRIGHT RESERVED. THE CONTRACTOR SHALL VERIFY THE ACCURACY OF THE INFORMATION PROVIDED. THE CONTRACTOR SHALL NOT SCALE THE DRAWING. ANY ERRORS OR OMISSIONS ARE THE RESPONSIBILITY OF THE CONTRACTOR. THE CONTRACTOR SHALL BE RESPONSIBLE FOR OBTAINING ALL NECESSARY PERMITS AND APPROVALS. THE CONTRACTOR SHALL BE RESPONSIBLE FOR OBTAINING ALL NECESSARY PERMITS AND APPROVALS. THE CONTRACTOR SHALL BE RESPONSIBLE FOR OBTAINING ALL NECESSARY PERMITS AND APPROVALS.

06/08/2022

EA-05
 SHEET 5 OF 10

ELEMENT 001

ALL DIMESIONS ARE IN INCHES

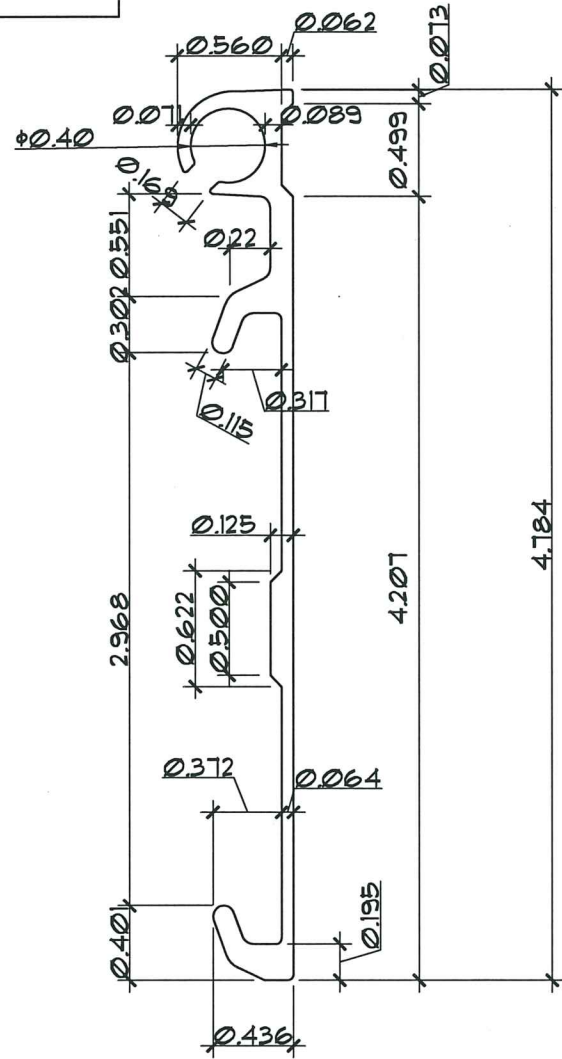

SIDE VIEW
SC: 1:1

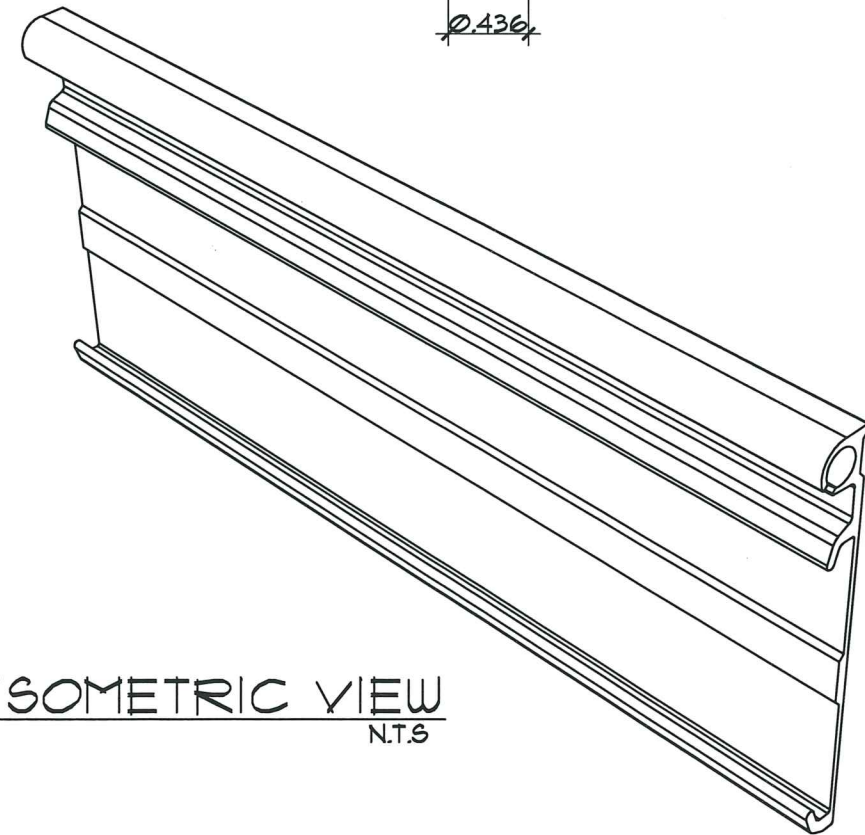

ISOMETRIC VIEW
N.T.S

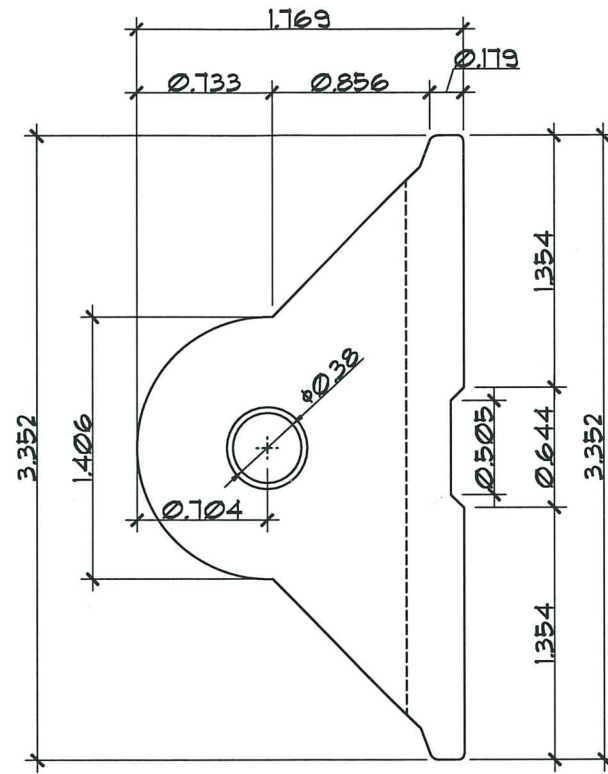

SIDE VIEW
SC: 1:1

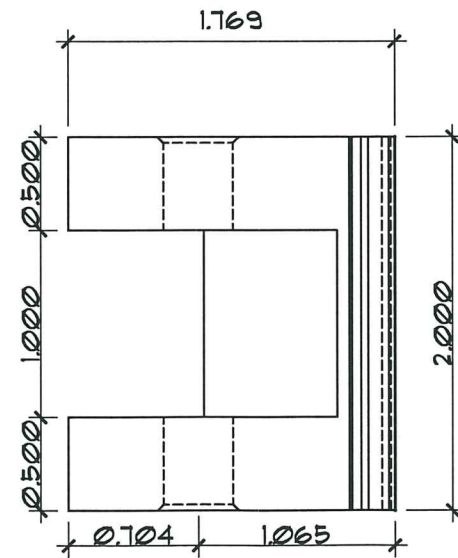

TOP VIEW
SC: 1:1

ELEMENT 002

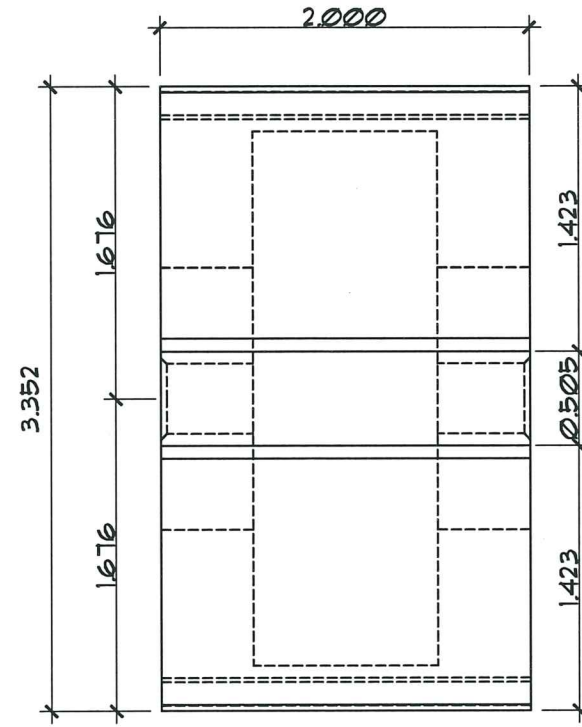

FRONT VIEW
SC: 1:1

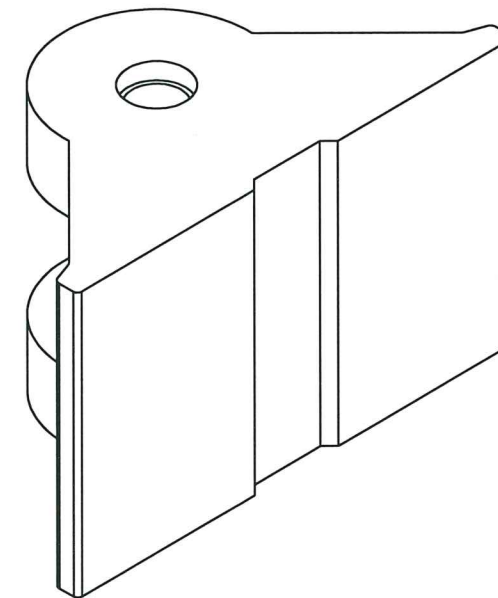

ISOMETRIC VIEW
N.T.S

PRODUCT REVISED
as complying with the Florida
Building Code
Acceptance No 21-1209.05
Expiration Date 12/15/2026
By *Heg A. Paz*
Miami Dade Product Control

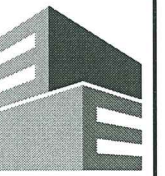
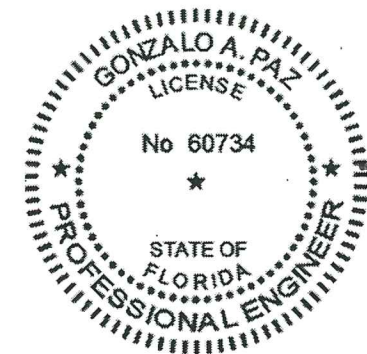

Eastern
Engineering Group

3401 NW 82nd Avenue
Suite 370
Miami, FL 33122

(305) 599-8133

info@easterneg.com

www.easterneg.com

REVISIONS	DATE
No. DESCRIPTION	
1 BCO COMMENTS 11/29/11	
2 CODE CHANGE 4/10/13	

JOB No. & NAME:
11 254
DESIGNED & DRAWN:
Mario Morales
SCALE: AS SHOWN

LAYZE SHADE - SERIES 002
EASY TERRACE AWNINGS
Address: 3480 NW 21 AVENUE, MIAMI FL 33142
PH: 786-256-4564

RASSA R. LOPEZ, PE (Lic No-50389)
 GONZALO A. PAZ, PE (Lic No-60734)
CERT. OF AUTHORIZATION No. 26655
I HEREBY CERTIFY THAT THE DESIGN, CALCULATIONS, AND SPECIFICATIONS OF THIS DRAWING ARE THE WORK OF THE ENGINEER OR ENGINEERS GROUP WHOSE NAME IS SET FORTH HEREON AND THAT I AM A LICENSED PROFESSIONAL ENGINEER IN THE STATE OF FLORIDA. I AM NOT PROVIDING ANY OTHER SERVICE THAN THAT FOR WHICH I AM LICENSED. ANY OTHER USE OF THIS DRAWING IS PROHIBITED. SHOP DRAWINGS CHECKED FOR STRUCTURAL REQUIREMENTS ONLY (ART 7.1855)

[Signature]
06/08/2022

EA-06
SHEET 6 OF 10

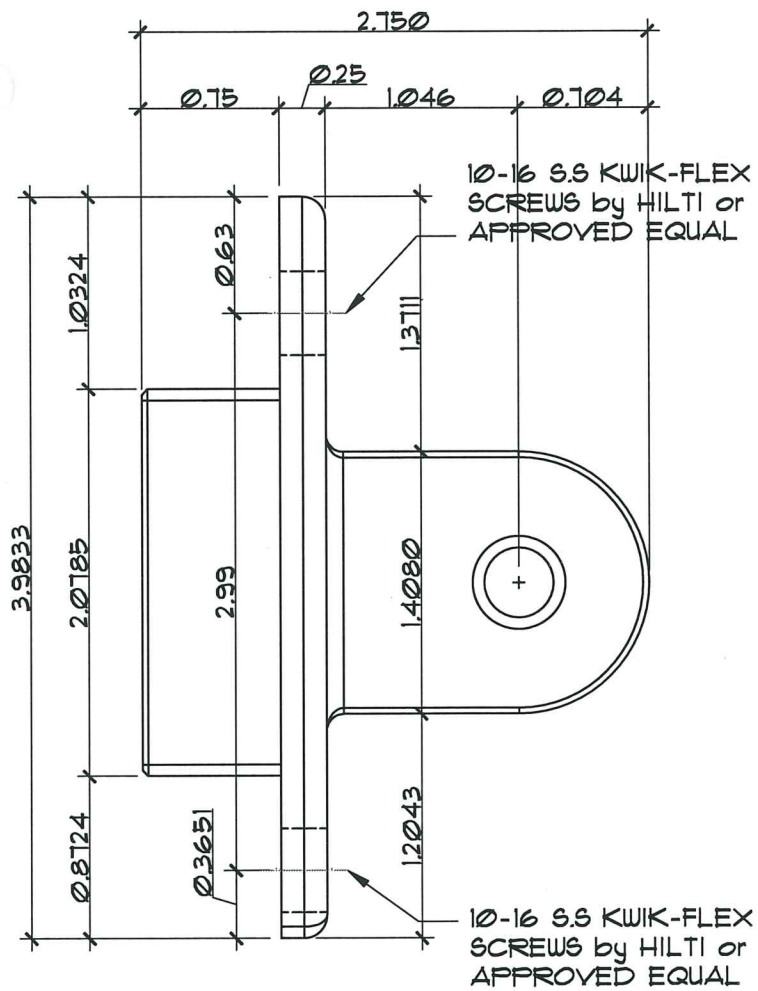

SIDE VIEW
SC: 1:1

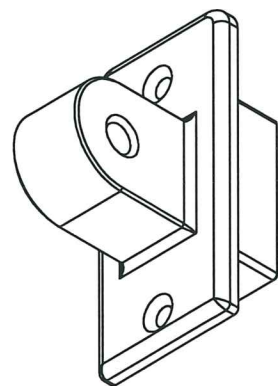

ISOMETRIC VIEW
N.T.S

ALL DIMESIONS ARE IN INCHES

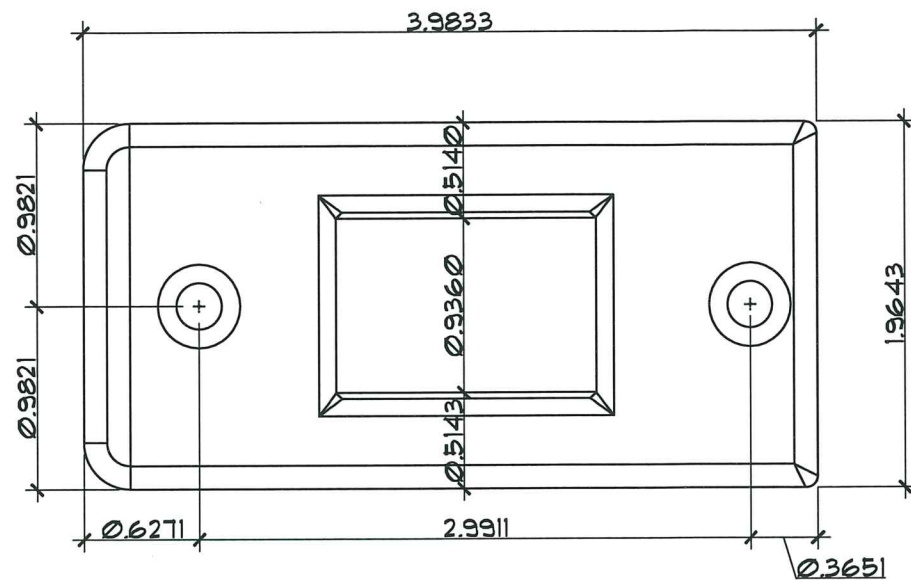

FRONT VIEW

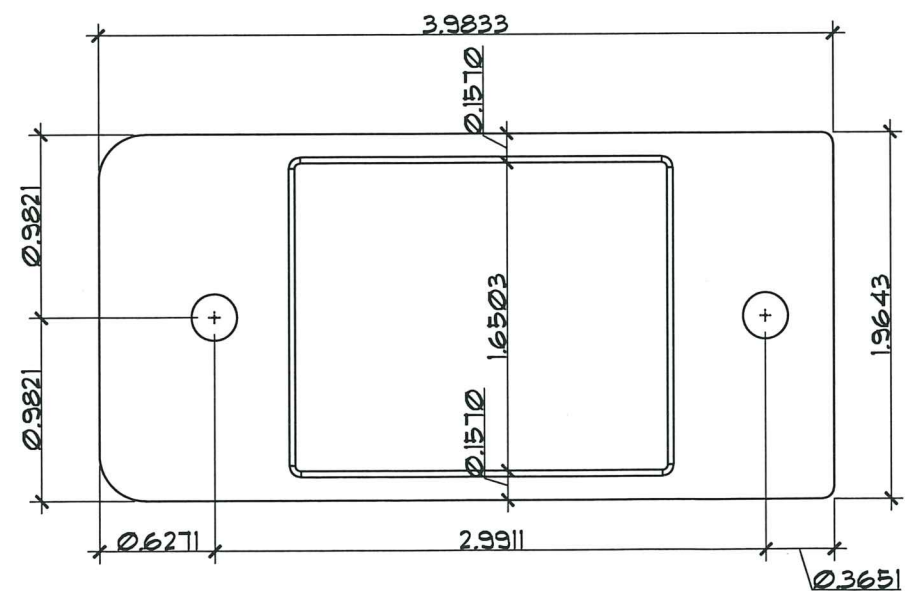

BOTTOM VIEW

ELEMENT 003

ELEMENT 004

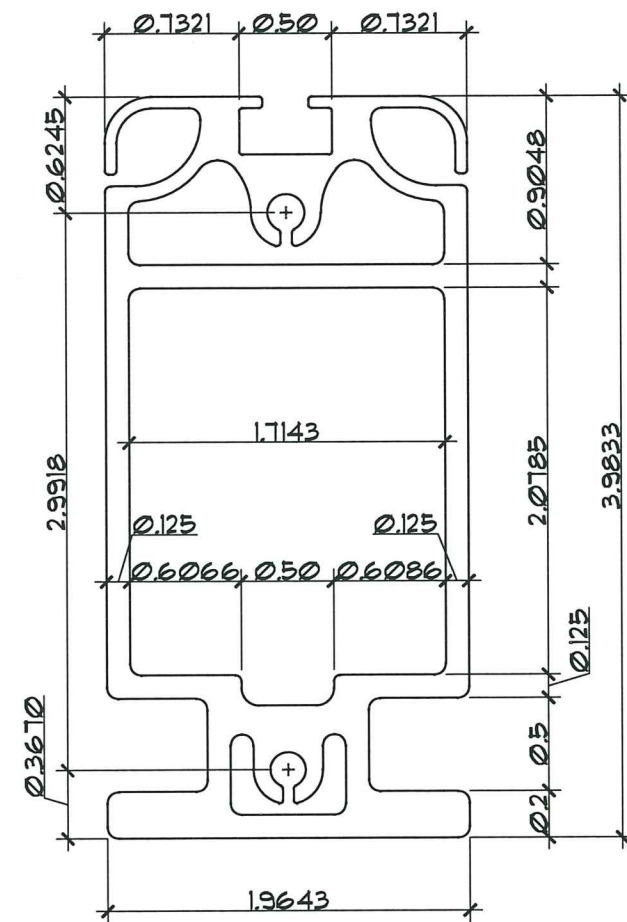

FRONT VIEW
SC: 1:1

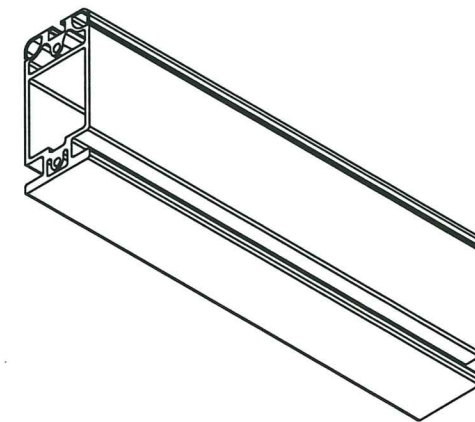

ISOMETRIC VIEW
N.T.S

PRODUCT REVISED
as complying with the Florida
Building Code
Acceptance No 21-1209.05
Expiration Date 12/15/2026
By *Hely A. Lopez*
Miami Dade Product Control

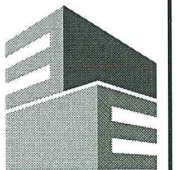
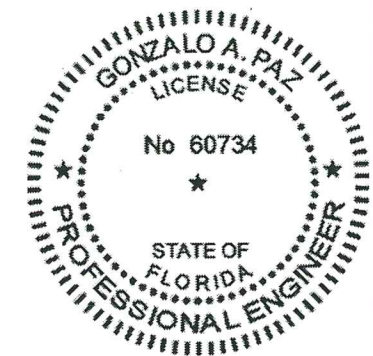

Eastern
Engineering Group

3401 NW 82nd Avenue
Suite 370
Miami, FL 33122

(305) 599-8133

info@easterneg.com

www.easterneg.com

REVISIONS	DATE
No. DESCRIPTION	
1 BIDD COMMENTS 11/20/11	
2 CODE CHANGE 4/10/13	

JOB No. & NAME:	11 254
DESIGNED & DRAWN:	Mario Morales
SCALE:	AS SHOWN

LAYZE SHADE - SERIES 002
EASY TERRACE AWNINGS

Address : 3480 NW 21 AVENUE, MIAMI FL 33142
Ph : 786-256-4564

BRASSA R. LOPEZ, PE (Lic No-58389)
 GONZALO A. PAZ, PE (Lic No-60734)
CERT. OF AUTHORIZATION No. 29655
COPYRIGHT RESERVED. THE CONTRACTOR SHALL
VERIFY THE DIMENSIONS AND CONDITIONS OF THE
DO NOT SCALE THE DRAWING. ANY ERRORS OR
OMISSIONS ARE THE RESPONSIBILITY OF THE
ENGINEER'S GROUP WITHOUT DELAY. THE COPYRIGHTS
OF THIS DRAWING ARE RESERVED. REPRODUCTION OR
USE FOR ANY PURPOSE OTHER THAN THAT
SPECIFICALLY AUTHORIZED BY THE ENGINEER'S GROUP
IS PROHIBITED. SHOP DRAWINGS CHECKED FOR
STRUCTURAL REQUIREMENTS ONLY CAN BE ISSUED

06/08/2022

EA-07

SHEET 7 OF 10

ALL DIMENSIONS ARE IN INCHES

ELEMENT 005

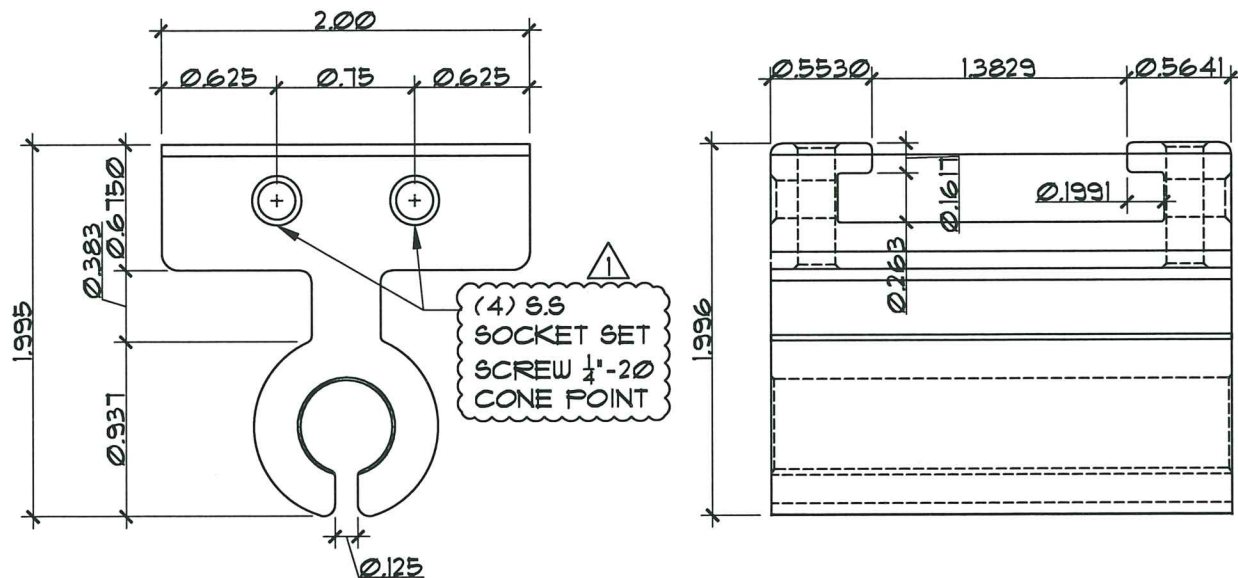

FRONT VIEW
SC: 1:1

TOP VIEW
SC: 1:1

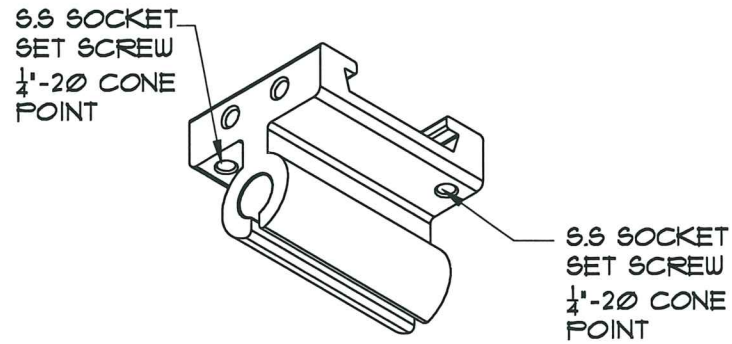

ISOMETRIC VIEW
N.T.S

FRONT VIEW
SC: 1:1

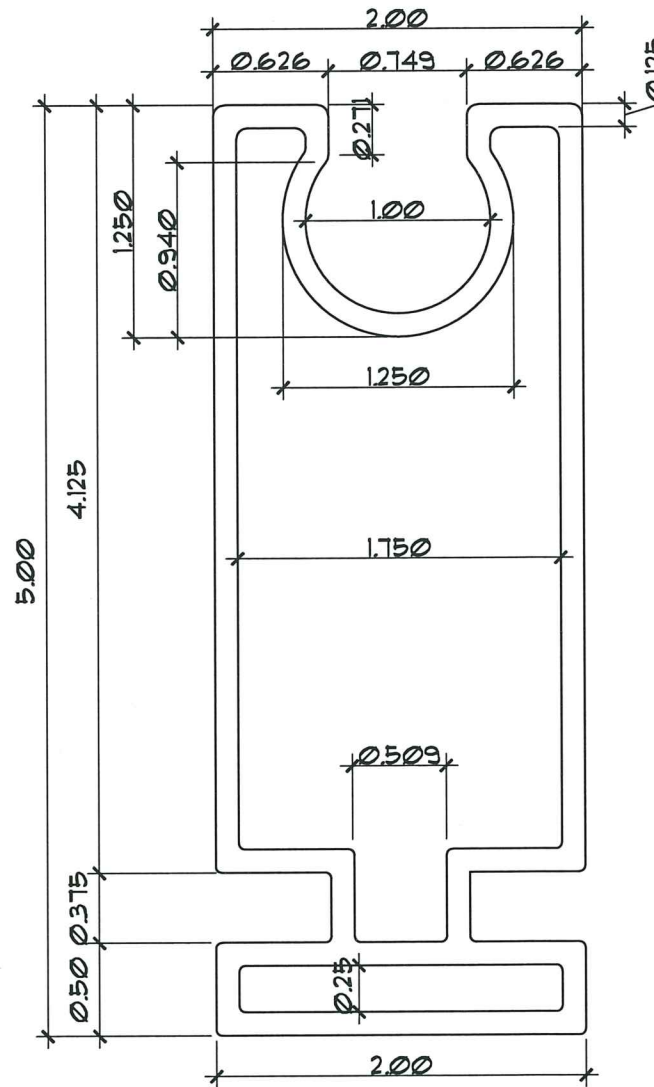

ELEMENT 006

ISOMETRIC VIEW
N.T.S

PRODUCT REVISED
as complying with the Florida
Building Code
Acceptance No 21-1209.05
Expiration Date 12/15/2026
By *Hely A. Maldonado*
Miami Dad Product Control

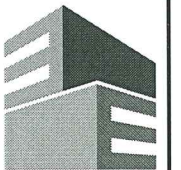
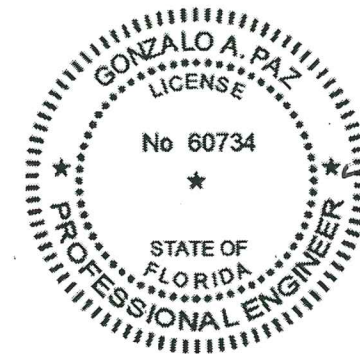

Eastern
Engineering Group

3401 NW 82nd Avenue
Suite 370
Miami, FL 33122

(305) 599-8133

info@easterneg.com

www.easterneg.com

NO.	DESCRIPTION	DATE
1	BIDD COMMENTS	11/29/11
2	CODE CHANGE	4/10/13

JOB No. & NAME:	11 254
DESIGNED & DRAWN:	Mario Morales
SCALE:	AS SHOWN

LAYZE SHADE - SERIES 002
EASY TERRACE AWNINGS
Address : 3480 NW 21 AVENUE, MIAMI FL 33142
Ph : 786-256-4564

BRASSA R. LOPEZ, PE (Lic No- 83309)
 GONZALO A. PAZ, PE (Lic No- 60734)
CERT. OF AUTHORIZATION No. 26655
COPYRIGHT RESERVED. THE CONTRACTOR, ARCHITECT, ENGINEER OR OTHER PROFESSIONAL PERSONS DO NOT SCALE THE DRAWING, ANY ERRORS OR OMISSIONS ARE THE RESPONSIBILITY OF THE CONTRACTOR, ARCHITECT, ENGINEER OR OTHER PROFESSIONAL PERSONS. NO PART OF THIS DRAWING IS TO BE REPRODUCED OR TRANSMITTED IN ANY FORM OR BY ANY MEANS, ELECTRONIC OR MECHANICAL, INCLUDING PHOTOCOPYING, RECORDING, OR BY ANY INFORMATION STORAGE AND RETRIEVAL SYSTEM, WITHOUT PERMISSION IN WRITING FROM EASTERN ENGINEERS GROUP. REPRODUCTION FOR ANY OTHER PURPOSE OTHER THAN THAT AUTHORIZED BY EASTERN ENGINEERS GROUP IS PROHIBITED. SHOP DRAWINGS CHECKED FOR STRUCTURAL REQUIREMENTS ONLY. DATE 7/26/05

06/08/2022

EA-08
SHEET 8 OF 10

ALL DIMESIONS ARE IN INCHES

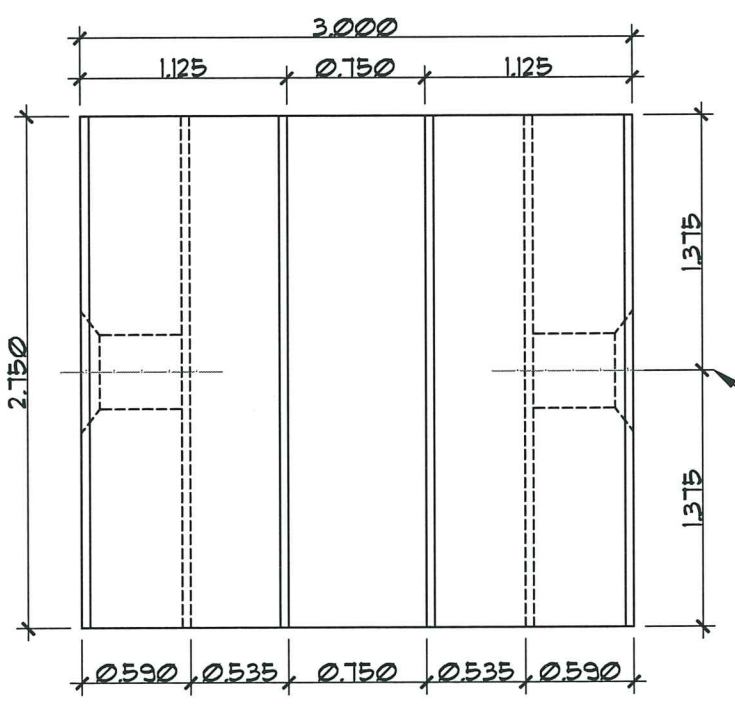

TOP VIEW
SC: 1:1

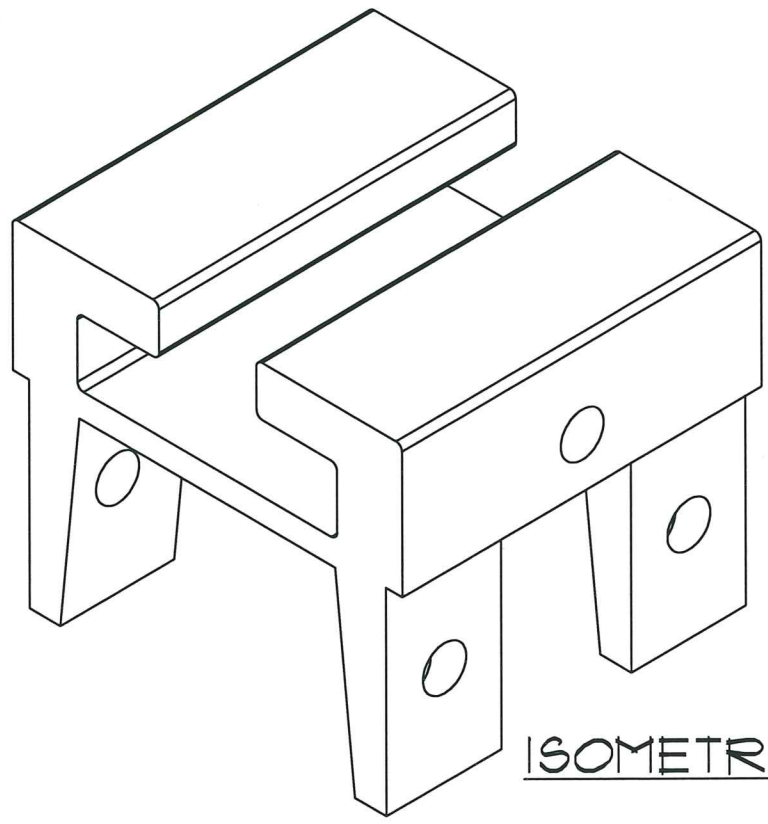

ISOMETRIC VIEW
N.T.S

ELEMENT 001

5.5 SOCKET SET SCREW
1/4"-20 CONE POINT

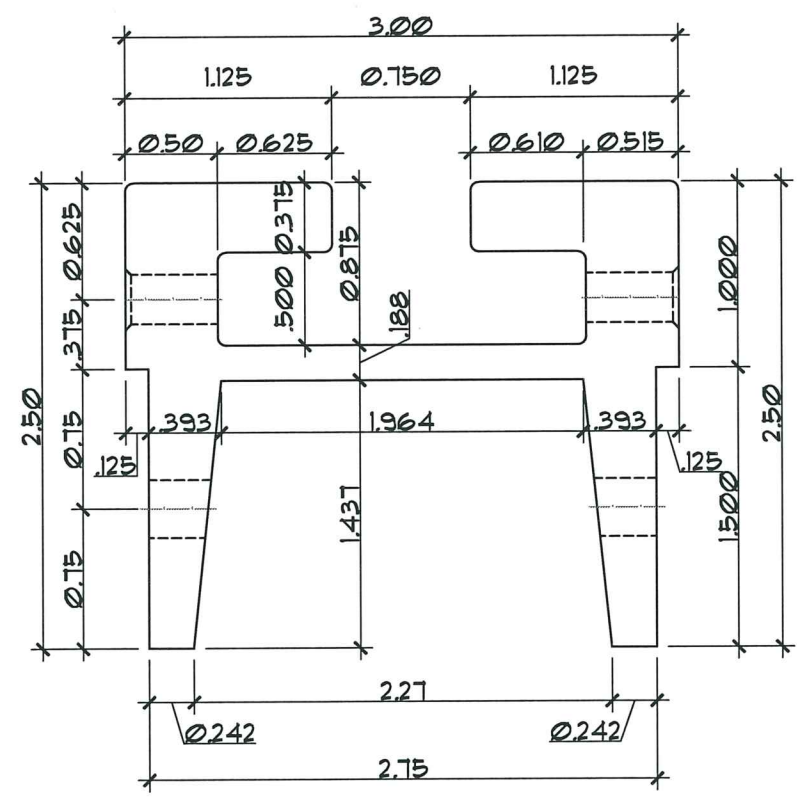

SIDE VIEW
SC: 1:1

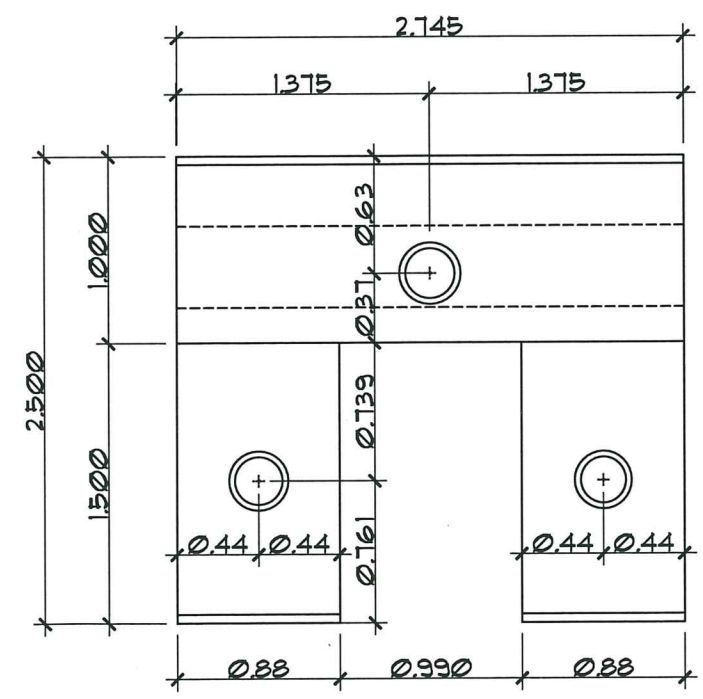

FRONT VIEW
SC: 1:1

PRODUCT REVISED
as complying with the Florida
Building Code
Acceptance No 21-1209.05
Expiration Date 12/15/2026
By *Heidi A. Miller*
Miami Dade Product Control

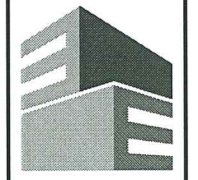
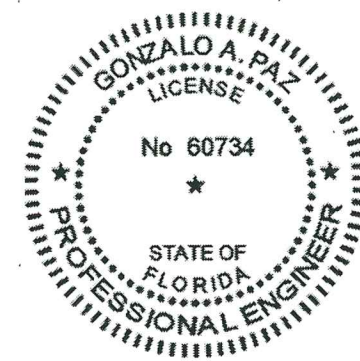

Eastern
Engineering Group

3401 NW 82nd Avenue
Suite 370
Miami, FL 33122

(305) 599-8133

info@easterneg.com

www.easterneg.com

REVISIONS	DATE
No. DESCRIPTION	
1 BIDD COMMENTS 11/29/11	
2 CODE CHANGE 4/10/13	

JOB No. & NAME:	11 254
DESIGNED & DRAWN:	Mario Morales
SCALE:	AS SHOWN

LAYZE SHADE - SERIES 002
EASY TERRACE AWNINGS
Address : 3480 NW 21 AVENUE, MIAMI FL 33142
Ph : 786-256-4564

BASSA R. LOPEZ, PE (Lic No-50399)
 GONZALO A. PAZ, PE (Lic No-60734)
CERT. OF AUTHORIZATION No. 26655
DO NOT SCALE THE DRAWING. ANY ERRORS OR OMISSIONS WILL BE RESPONSIBLE FOR ALL DIMENSIONS. THE ENGINEER'S GROUP WILL NOT RELAY THE COPYRIGHTS OF EASTERN ENGINEERS GROUP. REPRODUCTION OR USE FOR ANY PURPOSE OTHER THAN THAT FOR WHICH IT WAS DESIGNED IS PROHIBITED. SHOP DRAWINGS CHECKED FOR STRUCTURAL REQUIREMENTS ONLY. DATE 7/26/05

06/08/2022

EA-09
SHEET 9 OF 10

ALL DIMENSIONS ARE IN INCHES

ELEMENT 009

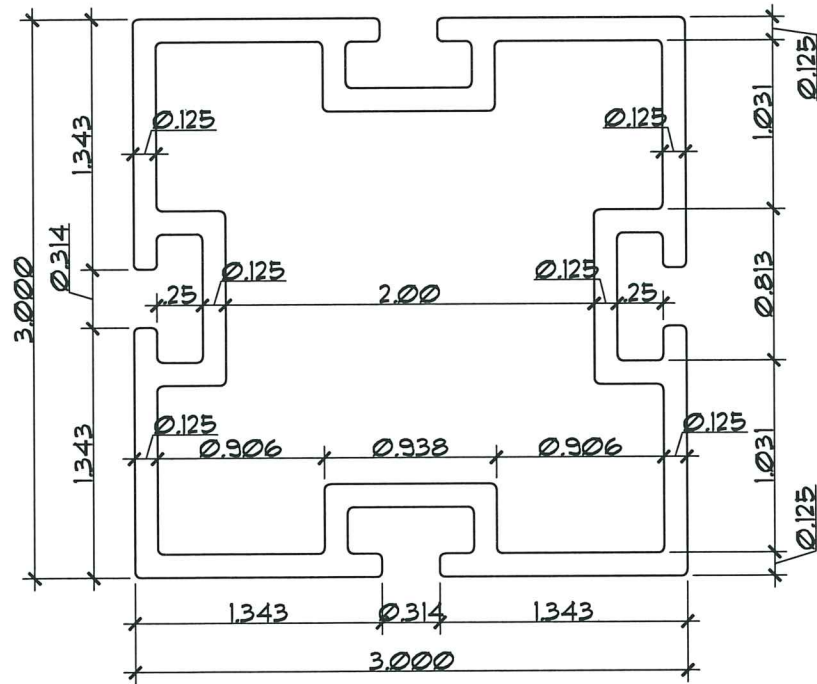

FRONT VIEW
SC: 1:1

ISOMETRIC VIEW
N.T.S

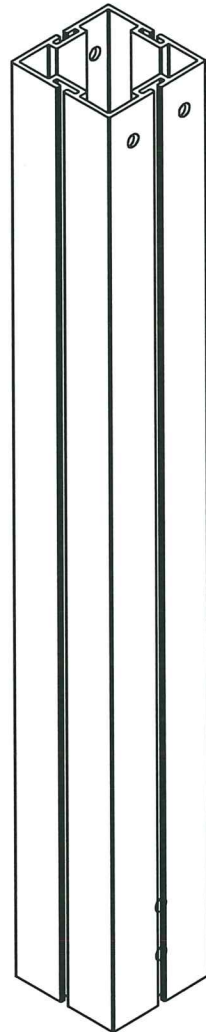

ELEMENT 010

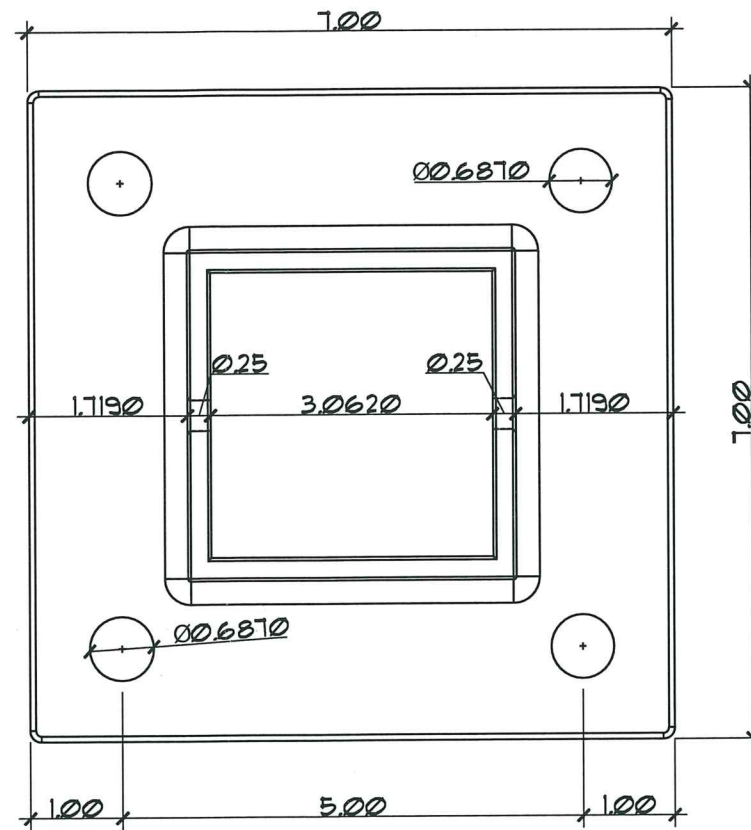

TOP VIEW
SC: 1"=2"

ISOMETRIC VIEW
N.T.S

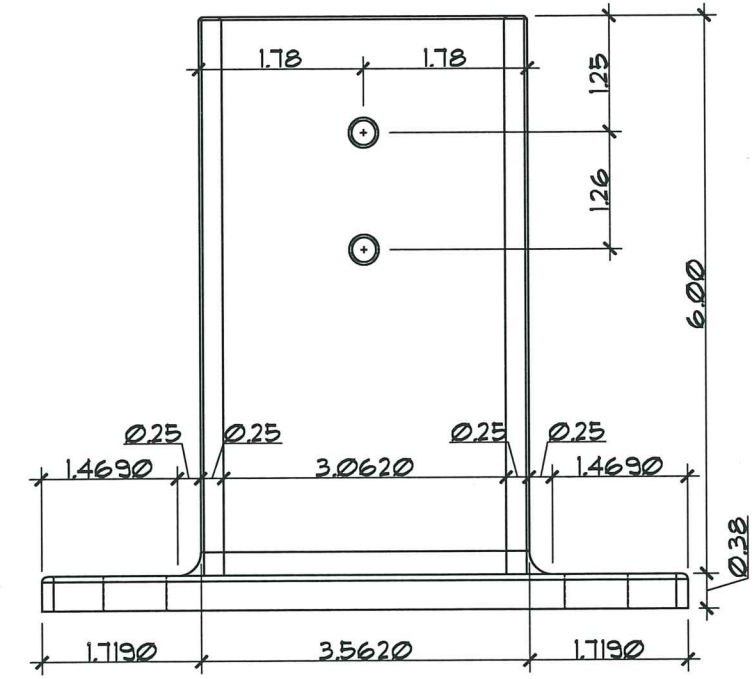
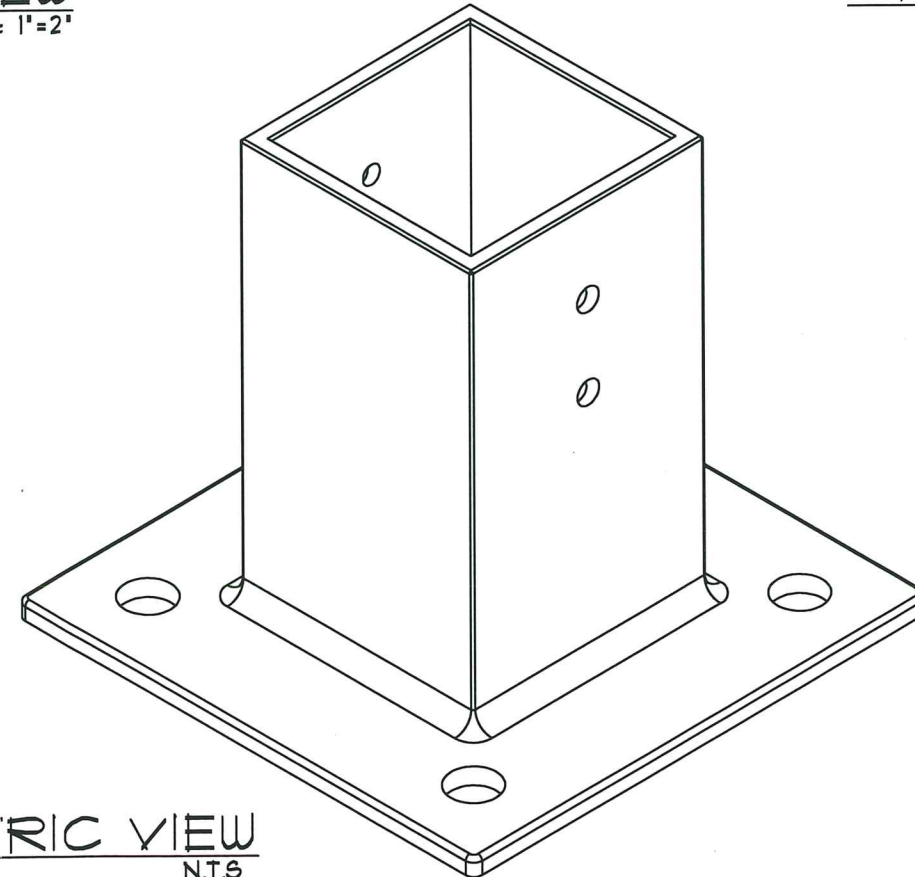

SIDE VIEW
SC: 1"=2"

PRODUCT REVISED
as complying with the Florida
Building Code
Acceptance No 21-1209.05
Expiration Date 12/15/2026
By *Heidi Miller*
Miami Date: Product Control

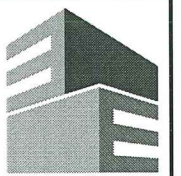
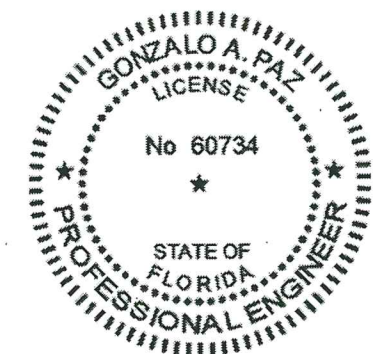

Eastern
Engineering Group

3401 NW 82nd Avenue
Suite 370
Miami, FL 33122

(305) 599-8133

info@easterneg.com

www.easterneg.com

REVISIONS	DATE
1	11/29/21
2	4/10/23

JOB No. & NAME:	11 254
DESIGNED & DRAWN:	Mario Morales
SCALE:	AS SHOWN

LAYZE SHADE - SERIES 002
EASY TERRACE AWNINGS
Address: 3480 NW 21 AVENUE, MIAMI FL 33142
Ph: 786-256-4564

MASSA R. LOPEZ, PE (Lic No-58398)
 GONZALO A. PAZ, PE (Lic No-60734)
 CERT. OF AUTHORIZATION No. 26655
 COPYRIGHT RESERVED. THE CONTRACTOR SHALL
 DO NOT SCALE THE DRAWING. ANY ERRORS OR
 OMISSIONS ARE THE RESPONSIBILITY OF THE
 ENGINEER GROUP. WITHOUT DELAY, THE CONTRACTOR
 TO ALL DESIGNS AND DRAWINGS ARE THE PROPERTY
 OF EASTERN ENGINEERING GROUP. NO PART OF THIS
 DRAWING IS TO BE REPRODUCED OR TRANSMITTED
 IN ANY FORM OR BY ANY MEANS, ELECTRONIC OR
 MECHANICAL, INCLUDING PHOTOCOPYING, RECORDING,
 OR BY ANY INFORMATION STORAGE AND RETRIEVAL
 SYSTEMS, WITHOUT PERMISSION IN WRITING FROM
 EASTERN ENGINEERING GROUP. STRUCTURAL REQUIREMENTS ONLY CAN BE USED.

[Signature]
06/08/2022

EA-10
SHEET 10 OF 10